

Sales - Plot - El Rosario
555.000€

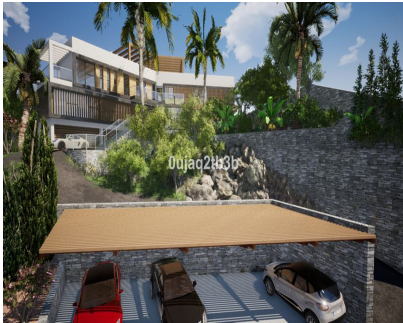

Ref.-ID: R3888871

El Rosario

Plot

IBI: 1,260 EUR / year

 1704 m2

Magnificent plot in a great location and walking distance to Sports center, commercial center, services and amenities. There is a project to build a very large house taking advantage of the slope in the plot. South-West oriented. El Rosario is a consolidated residential area with high demand for plots and properties.

Setting

- ✓ Close To Shops
- ✓ Urbanisation

Orientation

- ✓ West

Views

- ✓ Mountain
- ✓ Panoramic
- ✓ Garden
- ✓ Street

Utilities

- ✓ Electricity
- ✓ Drinkable Water
- ✓ Telephone

Category

- ✓ Golf
- ✓ Investment
- ✓ Resale
- ✓ With Planning Permission