

# Sales - Commercial - Puerto Banús

## 1.029.000€

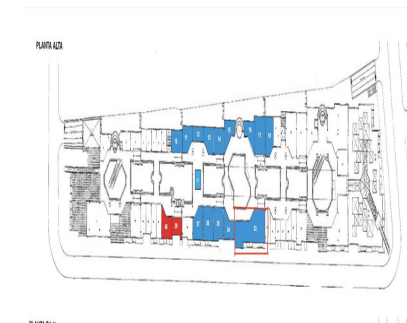
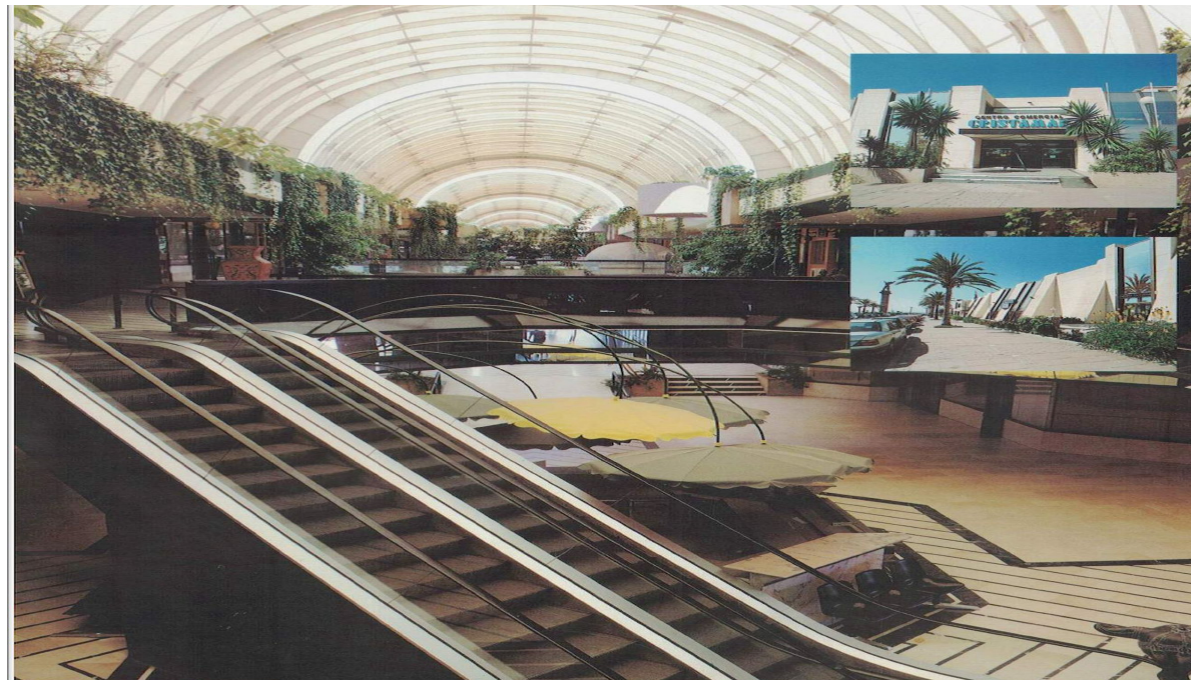

**Ref.-ID: R4333858**

**Puerto Banús**

**Commercial**

**Community: 2,160 EUR / year**

**Rubbish: 180 EUR / year**



**2**



**227 m2**

These are two units linked together. Cristamar is a mall comprises by 114 local comercial in the heart of Puerto Banus, three levels with underground parking for your clients on the ground floor restaurants , shops, and services, pharmacy at the north corner a gym, and on the second floor offices

### Setting

- ✓ Commercial Area
- ✓ Beachside
- ✓ Port
- ✓ Marina

### Condition

- ✓ Good

### Climate Control

- ✓ Air Conditioning

### Features

- ✓ Covered Terrace
- ✓ Lift

### Utilities

- ✓ Electricity
- ✓ Drinkable Water

### Category

- ✓ Investment
- ✓ Resale